

## Choose the right screen for the job

Saint-Gobain ADFORS offers a variety of specialty screen types to meet any need.



### Clear Advantage™

Best visibility - allows more natural light

Recommended spline .140



### Extra Strength

Long lasting durability

Recommended spline .140



### Pet Resistant

Withstands damage from household pets

Recommended spline .125



### Small Insect

Greater protection from tiny insects

Recommended spline .140



### Sun Guard

Controls the damaging effects of the sun

Recommended spline .140

## Also available

- Standard Fiberglass  
Recommended spline .140
- Aluminum  
Recommended spline .125

## Tools & materials required:

- Screen at least 2" (5 cm) wider than screen frame
- Screen tool
- New spline
- Utility knife



1. Lay screen over frame on flat surface, overlapping spline groove at least 2" on all four sides.

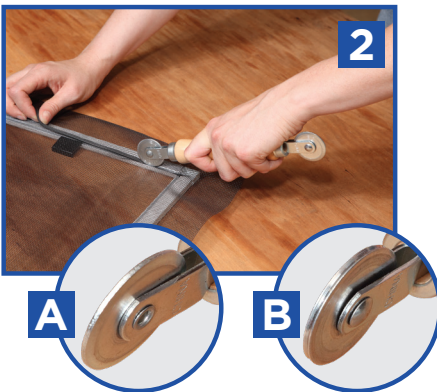

2. **A:** For aluminum screen, use the convex end of screen tool to gently roll screen into the frame groove to crease the screen.

**B:** Using concave end of screen tool, insert spline at one corner and roll into groove over screen. Place hand on screen surface to hold screen straight. Roll spline into groove on all four sides.



3. Trim off excess screen with utility knife on outside edge of the spline groove.



SAINT-GOBAIN ADFORS  
America, Inc.

1795 Baseline Road  
Grand Island, NY 14072 - USA  
Phone: 800-762-6694  
Fax: 716-775-3902  
www.adfors.com

Visit [www.adfors.com](http://www.adfors.com) to learn more about our products, view our how-to videos, and use our screen selector tool to make sure you have the right screen for your needs.

